

Emergency Department & In-patient Collection Devices (Xpert)



Endocervical, vaginal, rectal, and pharyngeal collection device



Urine collection device

Contact BJH Lab Customer Service with questions: 314-362-1470

Urine Specimen Collection (First Catch) for the Xpert CT/NG and Xpert TV Assays

Direct patient to provide first-catch urine (20-50mL) into a urine collection cup free of any preservatives.

1

Note: Prior to urine specimen collection, the patient should not have urinated for at least 1 hour and should not have cleansed the genital area (female patient) or the tip of the penis (male patient).

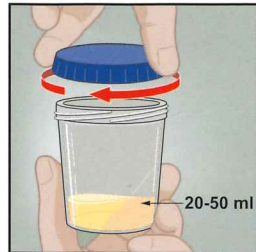

Mix specimen well. Transfer approximately 7mL of urine into the transport tube, using the disposable transfer pipette. Note the black dashed line on the transport tube label and fill to the line for the correct fill volume.

5

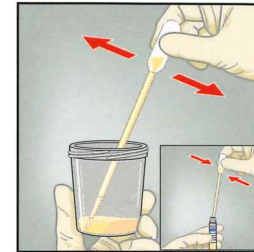

The Xpert® Urine Specimen Collection kit contains

2

- A Large, disposable transfer pipette
- B Urine Transport Reagent tube (Yellow cap)

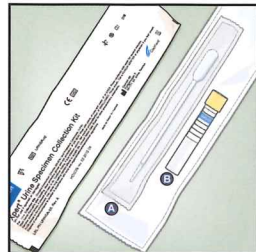

Replace the yellow cap on the transport tube and tighten securely.

6

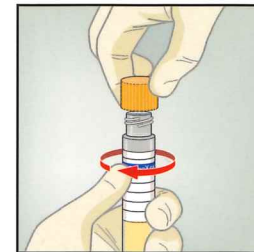

Open the package of disposable transfer pipette provided in the kit.

3

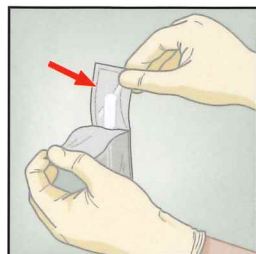

Invert the transport tube 3-4 times to ensure that the specimen and reagent are well mixed.

7

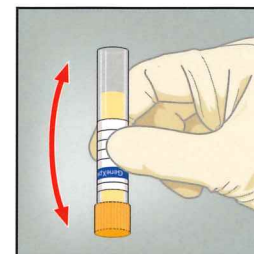

Remove the yellow cap from the transport tube.

4

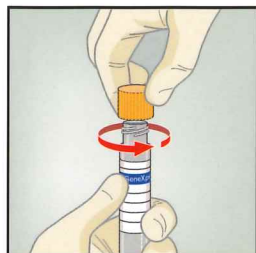

Label the transport tube with the sample identification information, including date of the collection, as required. Do not obscure the black dashed fill line on the Xpert Urine Transport Reagent tube.

8

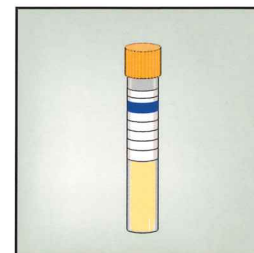

Endocervical Specimen Collection

- 1
- The Xpert Vaginal/Endocervical Specimen Collection kit contains
- A Individual Collection Kit
 - B Cleaning Swab

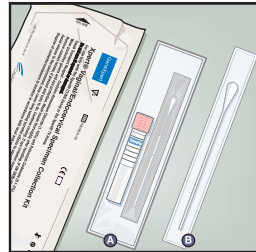

- 2
- Partially peel open the cleaning swab wrapper and remove the swab.
- Remove excess mucus from the cervical os and surrounding mucosa using the large individually wrapped cleaning swab B.
- Discard the swab.

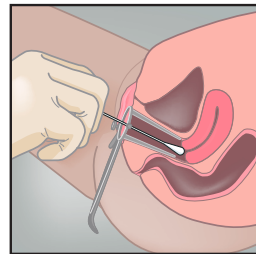

- 3
- Open package A that contains the pink-capped Xpert Swab Transport Reagent tube and the individually wrapped collection swab. Set the tube aside before beginning to collect sample.
- Open the collection swab wrapper by peeling open the top of the wrapper. Remove the swab, taking care not to touch the tip or lay it down.
- If the soft tip is touched, the swab is laid down, or the swab is dropped, use a new Xpert Vaginal/Endocervical Specimen Collection Kit.

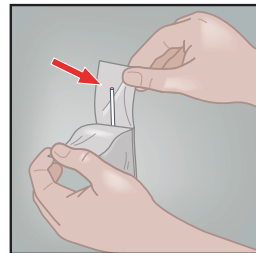

- 4
- Hold the swab in your hand, placing your thumb and forefinger in the middle of the swab shaft.

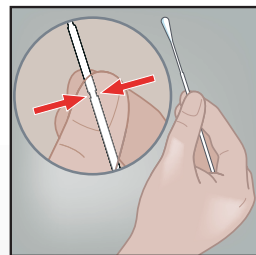

- 5
- Insert the collection swab into the endocervical canal. Gently rotate the swab clockwise for 10-30 seconds in the endocervical canal.
- Withdraw the swab carefully.

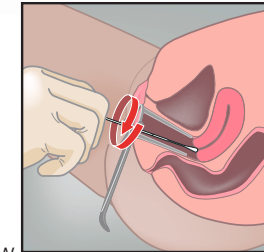

- 6
- While holding the swab in the same hand, unscrew the cap from the Xpert Swab Transport Reagent tube. Do not spill the contents of the tube. If the contents of the tube are spilled, use a new collection kit. Immediately place the collection swab into the transport reagent tube.



WARNING: If the contents of the tube are spilled on your skin, wash the affected area with soap and water. If the contents of the tube are splashed in your eyes, immediately flush your eyes with water. Notify your doctor, nurse or care-provider if irritation develops. If the contents of the tube are spilled, your test result may be invalidated. Do not take internally.

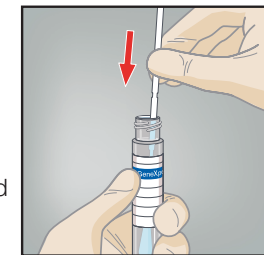

- 7
- Identify the scoreline on the collection swab shaft. Carefully break the swab shaft against the side of the tube at the scoreline. If needed, gently rotate the swab shaft to complete the breakage. Discard the top portion of the swab shaft.

Use care to avoid splashing the contents. Wash with soap and water if exposed.

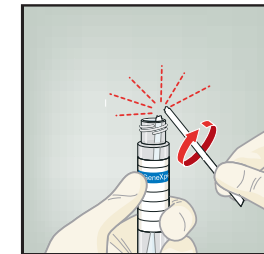

- 8
- Re-cap the swab transport reagent tube and tighten the cap securely. Invert or gently shake the tube 3-4 times to elute material from the swab. Avoid foaming.
- Label the transport tube with the sample identification information, including date of the collection, as required.

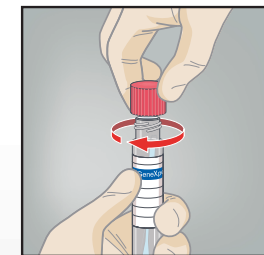

Patient-Collected Vaginal Swab Specimen Collection

1 Wash hands before starting and undress from the waist down. Open the individual collection package **A** that contains the pink-capped Xpert® Swab Transport Reagent tube and individually wrapped collection swab. Set the tube aside before beginning to collect sample. Discard the larger swab **B**.

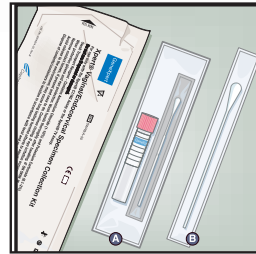

5 Gently rotate the swab for 10 – 30 seconds. Ensure the swab touches the walls of the vagina so that moisture is absorbed by the swab. Withdraw the swab and continue to hold it in your hand.

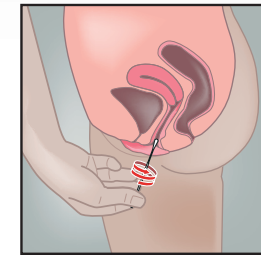

While holding the swab in the same hand, unscrew the cap from the Xpert Swab Transport Reagent tube. Do not spill the contents of the tube. If the contents of the tube are spilled, request a new collection kit. Immediately place the collection swab into the transport reagent tube.

6 **WARNING:** If the contents of the tube are spilled on your skin, wash the affected area with soap and water. If the contents of the tube are splashed in your eyes, immediately flush your eyes with water. Notify your doctor, nurse or care-provider if irritation develops. If the contents of the tube are spilled, your test result may be invalidated. Do not take internally.

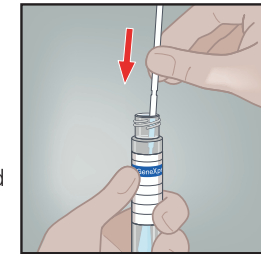

2 Open the collection swab wrapper by peeling open the top of the wrapper.

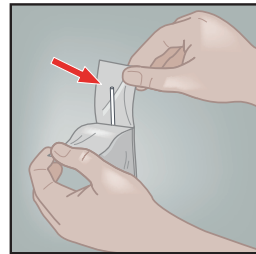

Remove the swab, taking care not to touch the tip or lay it down. If the soft tip is touched, the swab is laid down, or the swab is dropped, request a new collection kit.

7 Identifying the scoreline on the collection swab shaft, carefully break the swab shaft against the side of the tube at the scoreline. If needed, gently rotate the swab shaft to complete the breakage. Discard the top portion of the swab shaft. Avoid splashing contents on the skin. Wash with soap and water if exposed.

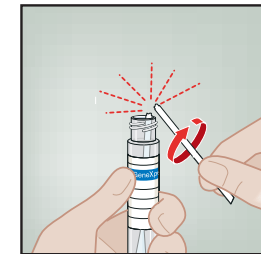

3 Hold the swab in your hand, placing your thumb and forefinger in the middle of the swab shaft across the scoreline.

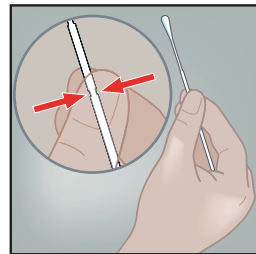

8 Re-cap the transport tube and tighten the cap securely.

Return the tube as instructed by your doctor, nurse or care-provider.

Note: Health care provider should invert or gently shake the tube 3-4 times to elute material from the swab. Avoid foaming. Label the transport tube with the sample identification information, including date of the collection, as required.

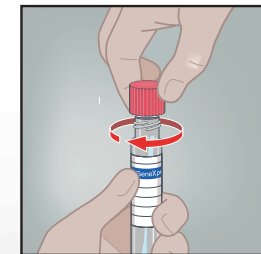

4 Carefully insert the swab into your vagina about 5 cm (two inches) inside the opening of the vagina.

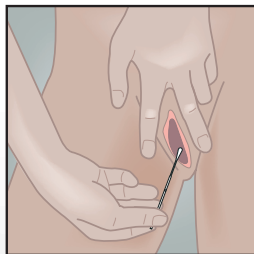

Clinician-Collected Rectal Swab Specimen Collection

For use with Xpert® Swab Specimen Collection Kit – Catalog #SWAB/G-50

1 Wash hands before starting. Open the individual collection package **A** that contains the pink-capped Xpert Swab Transport Reagent tube and individually wrapped collection swab. Set the tube aside before beginning to collect sample. Discard the larger swab **B**.

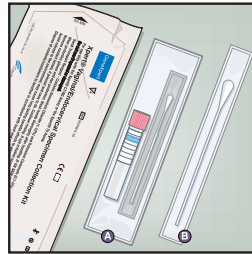

2 Open the collection swab wrapper by peeling open the top of the wrapper. Remove the swab, taking care not to touch the tip or lay it down.

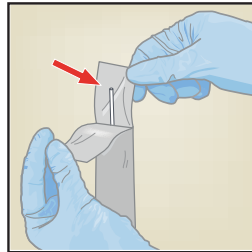

If the soft tip is touched, the swab is laid down, or the swab is dropped, use a new collection kit.

3 Hold the swab in your hand, placing your thumb and forefinger in the middle of the swab shaft across the scoreline.

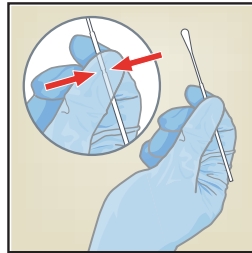

4 Carefully insert the swab approximately 1 cm beyond the anal sphincter (so that the fiber tips are no longer visible), and rotate gently for 10 seconds.

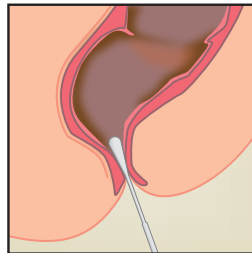

5 While holding the swab in the same hand, unscrew the cap from the Xpert Swab Transport Reagent tube. Do not spill the contents of the tube. If the contents of the tube are spilled, use a new collection kit. Immediately place the collection swab into the transport reagent tube.

WARNING: If the contents of the tube are spilled on your skin, wash the affected area with soap and water. If the contents of the tube are splashed in your eyes, immediately flush your eyes with water.

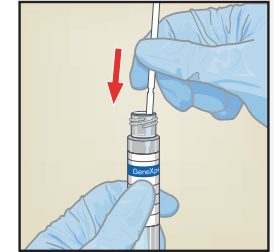

6 Identifying the scoreline on the collection swab shaft, carefully break the swab shaft against the side of the tube at the scoreline and discard the top portion of the swab shaft. If needed, gently rotate the swab shaft to complete the breakage. Avoid splashing contents on the skin. Wash with soap and water if exposed.

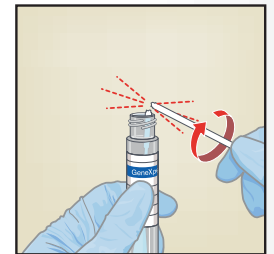

7 Re-cap the transport tube and tighten the cap securely.

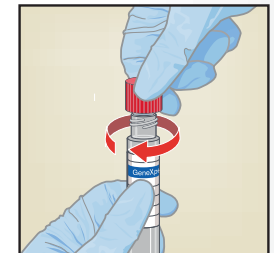

8 Invert or gently shake the tube 3-4 times to elute material from the swab. Avoid foaming. Label the transport tube with the sample identification information, including date of the collection, as required.

Specimen should be transported at 2-30 °C.

Prior to testing, specimen may be stored for up to 60 days at 2-30 °C.

Swab Examples

Acceptable Swabs



Unacceptable Swabs

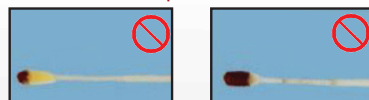

Clinician-Collected Pharyngeal Swab Specimen Collection

For use with Xpert® Swab Specimen Collection Kit – Catalog #SWAB/G-50

1 Wash hands before starting. Open the individual collection package **A** that contains the pink-capped Xpert Swab Transport Reagent tube and individually wrapped collection swab. Set the tube aside before beginning to collect sample. Discard the larger swab **B**.

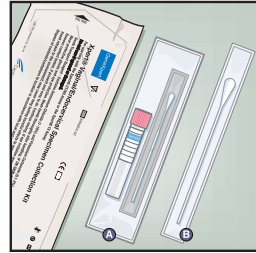

5 While holding the swab in the same hand, unscrew the cap from the Xpert Swab Transport Reagent tube. Do not spill the contents of the tube. If the contents of the tube are spilled, use a new collection kit. Immediately place the collection swab into the transport reagent tube. **WARNING:** If the contents of the tube are spilled on your skin, wash the affected area with soap and water. If the contents of the tube are splashed in your eyes, immediately flush your eyes with water.

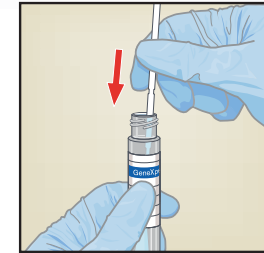

2 Open the collection swab wrapper by peeling open the top of the wrapper. Remove the swab, taking care not to touch the tip or lay it down. If the soft tip is touched, the swab is laid down, or the swab is dropped, use a new collection kit.

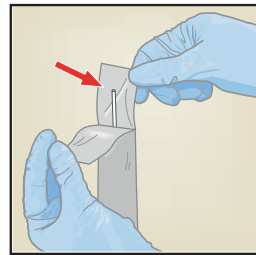

6 Identifying the scoreline on the collection swab shaft, carefully break the swab shaft against the side of the tube at the scoreline and discard the top portion of the swab shaft. If needed, gently rotate the swab shaft to complete the breakage. Avoid splashing contents on the skin. Wash with soap and water if exposed.

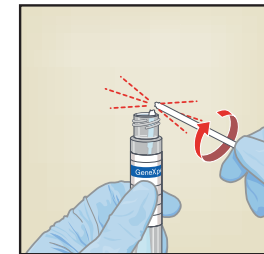

3 Hold the swab in your hand, placing your thumb and forefinger in the middle of the swab shaft across the scoreline.

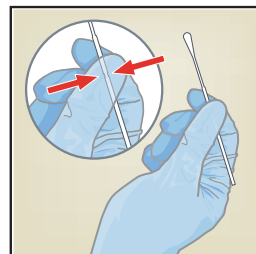

7 Re-cap the transport tube and tighten the cap securely.

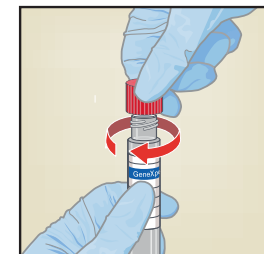

4 Instruct the patient to open mouth widely. Position the tongue toward the bottom of the mouth. Swab areas of the pharynx (tonsil, posterior wall, uvula, posterior wall).

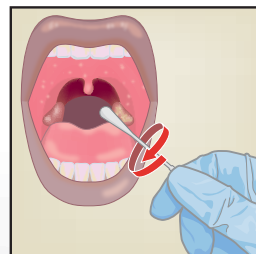

8 Invert or gently shake the tube 3-4 times to elute material from the swab. Avoid foaming. Label the transport tube with the sample identification information, including date of the collection, as required. Specimen should be transported at 2-30 °C. Prior to testing, specimen may be stored for up to 60 days at 2-30 °C.